

**MAINS TERMINAL BLOCK
INSTALLING**

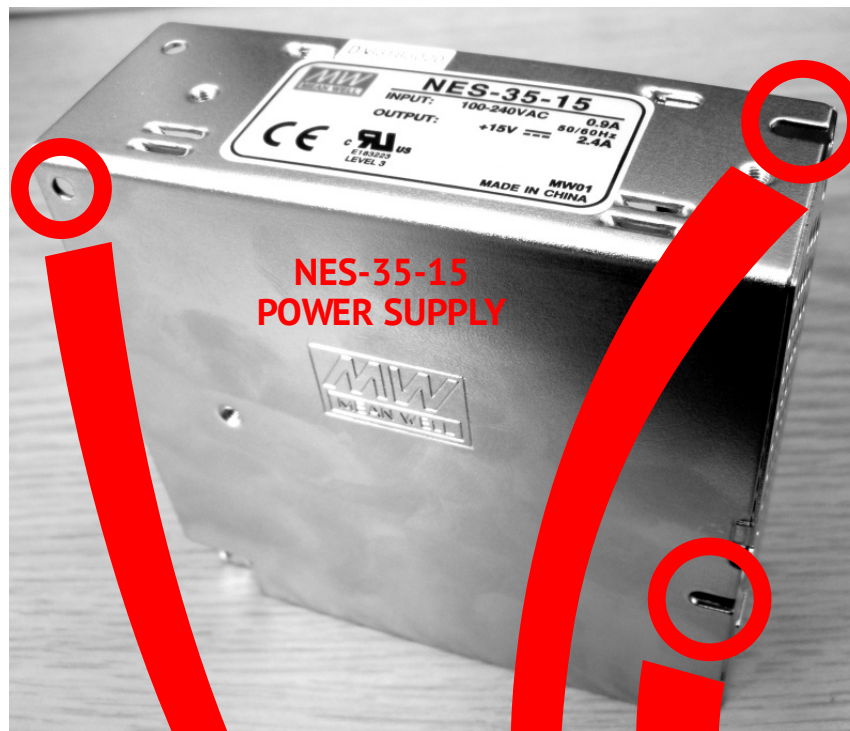

FIXING PLACES IN HOUSING

**NES-35-15
POWER SUPPLY
INSTALLING**

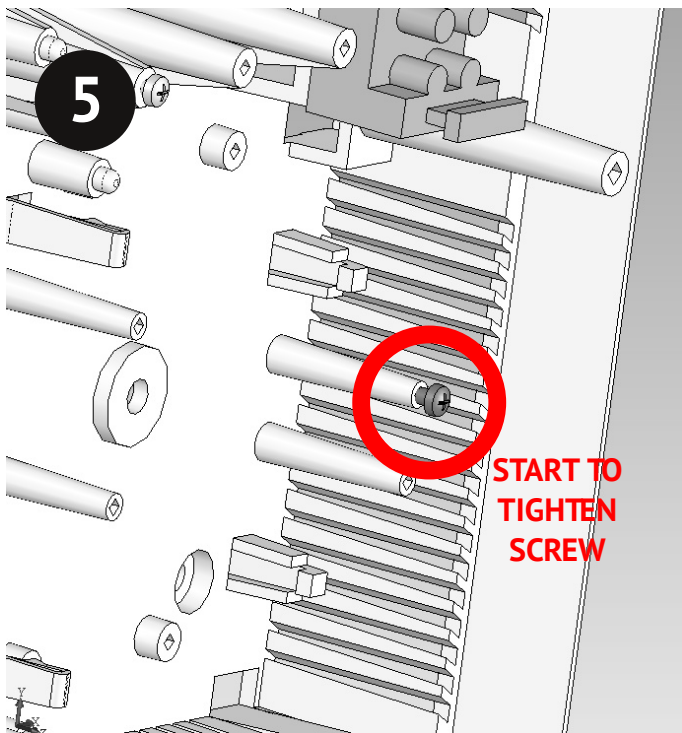
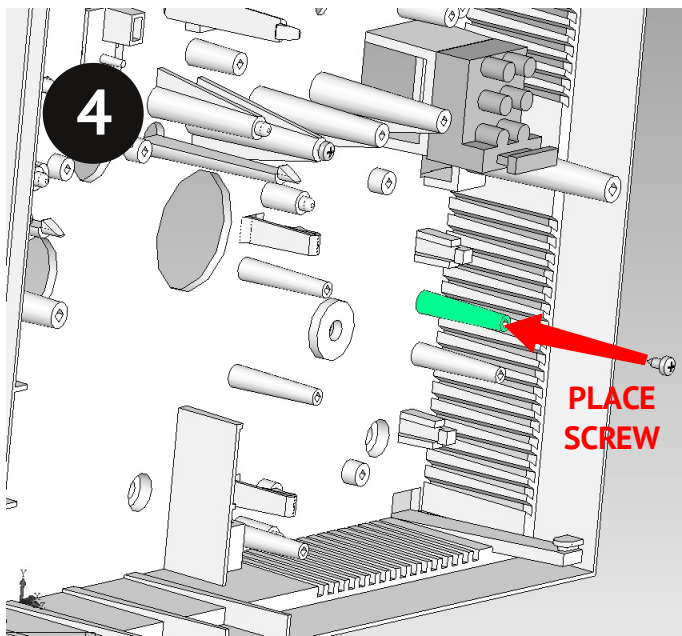
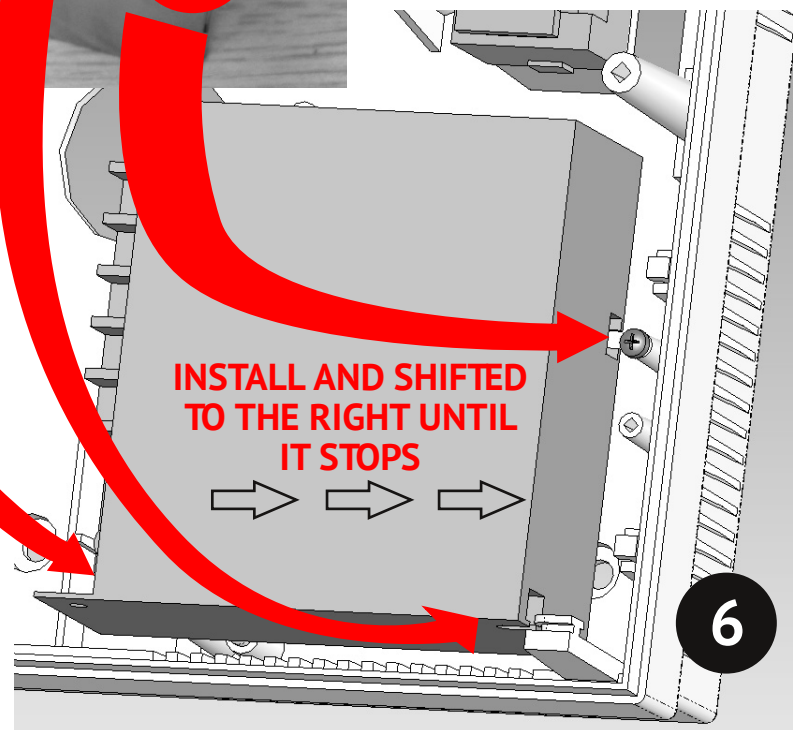

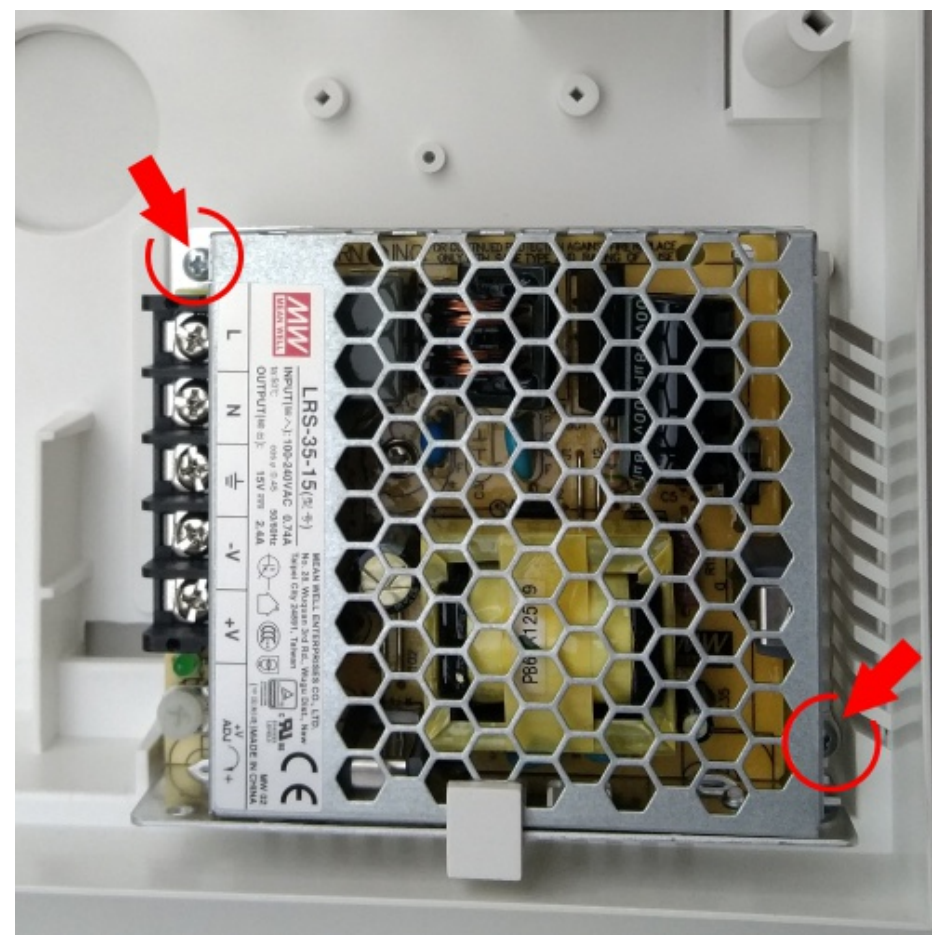
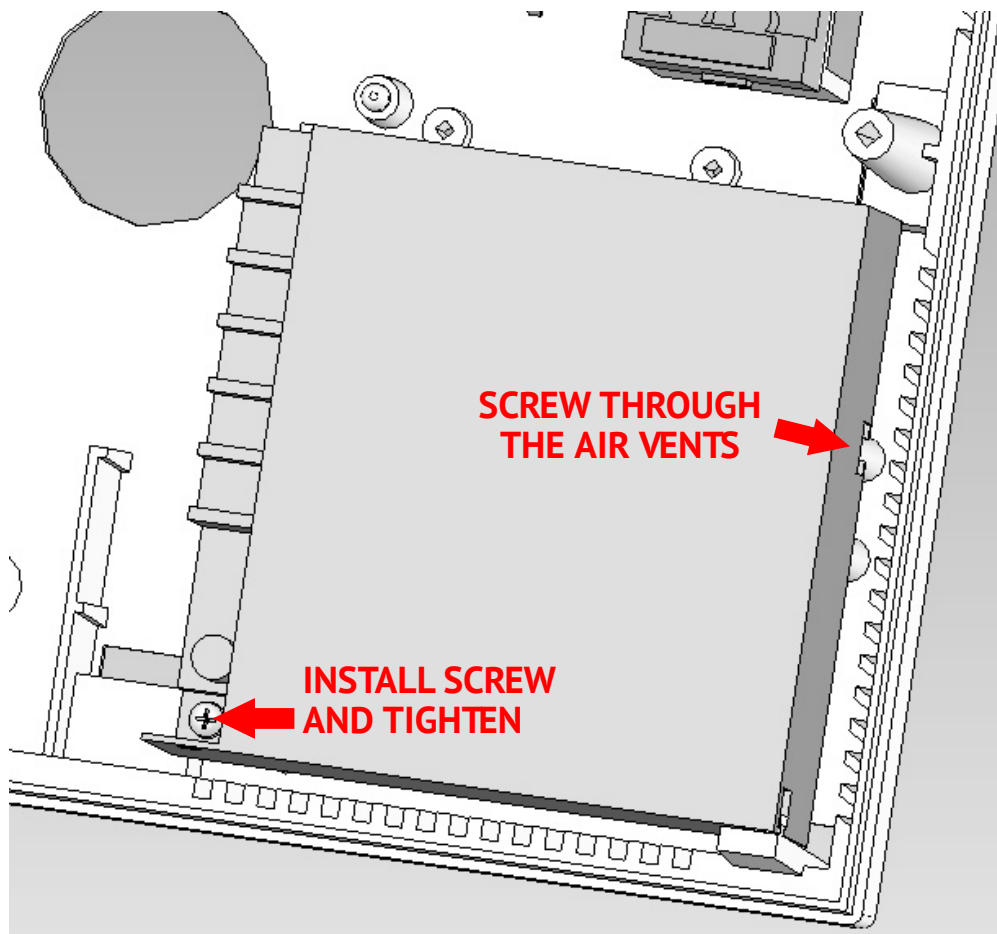

**FIX THE POWER SUPPLY BY
SCREWS 2.9x6.5**

**NES-35-15
POWER SUPPLY
INSTALLING**

7

**LRS-35-15
POWER SUPPLY
INSTALLING**

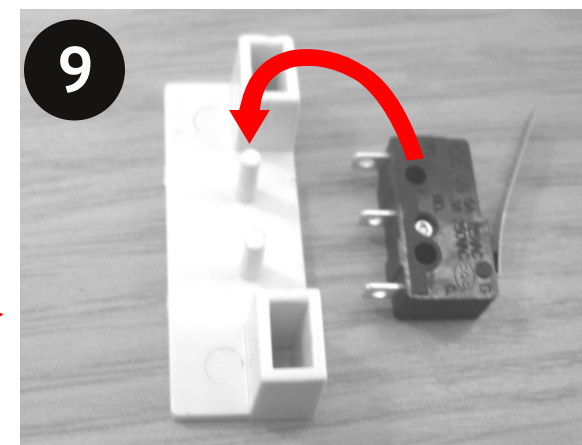
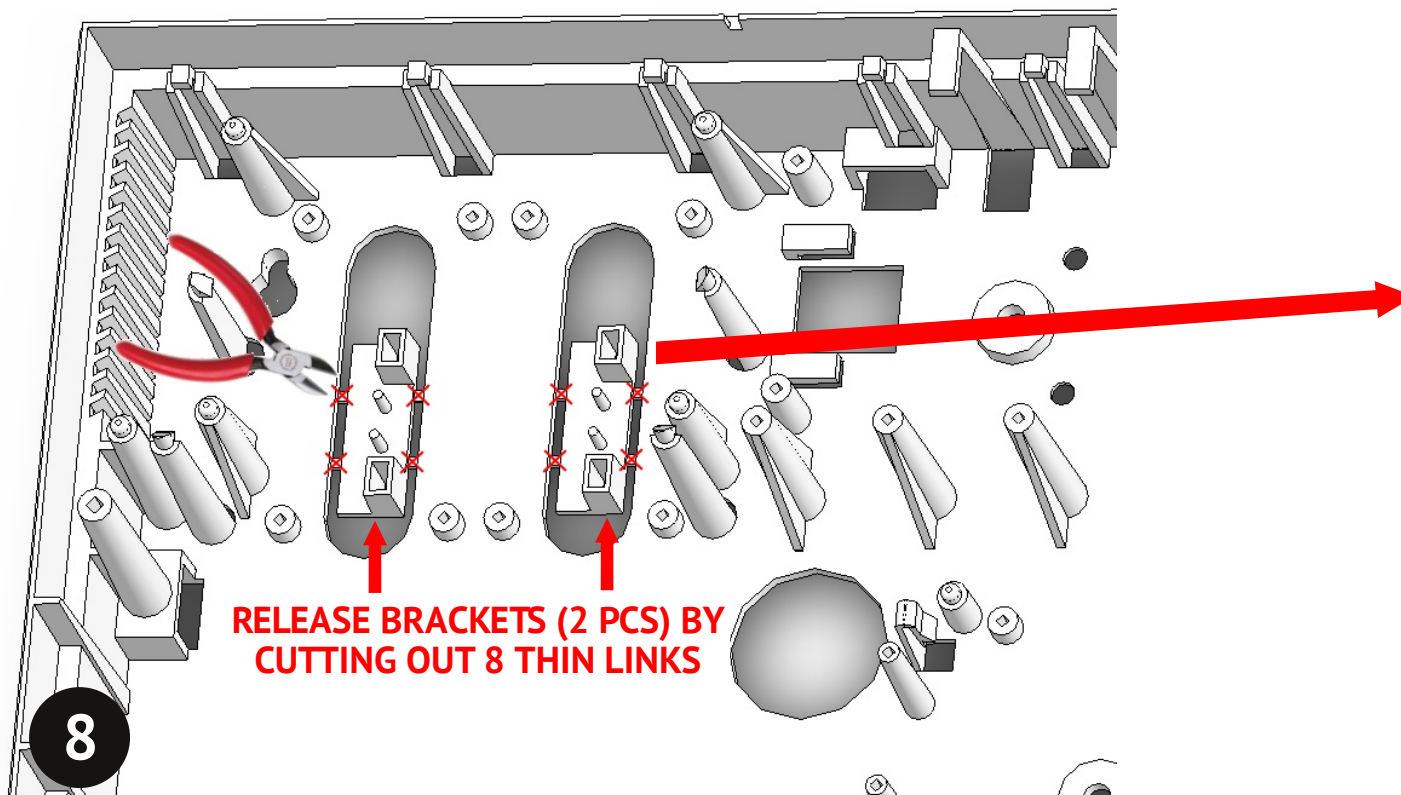

TAMPER BUTTON PLACE TO THE BRACKET, ALIGNING TWO HOLES WITH HOLDERS

INSTALLING TAMPER BUTTON TO THE BRACKET

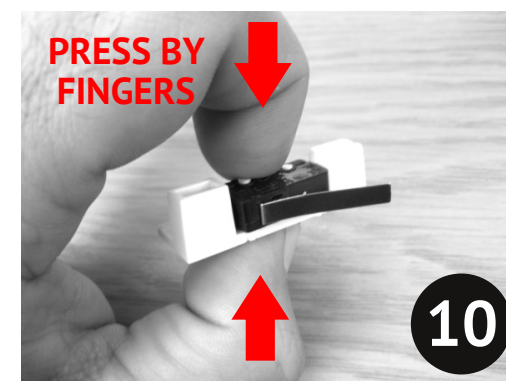

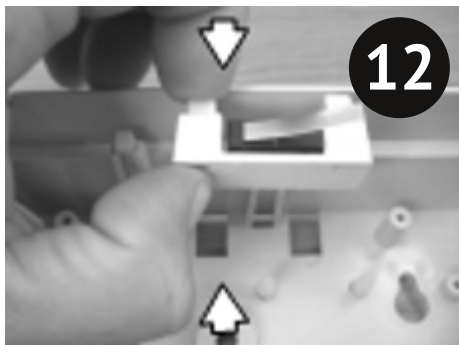

**SET THE BRACKET WITH
TAMPER TO CATCHERS...**

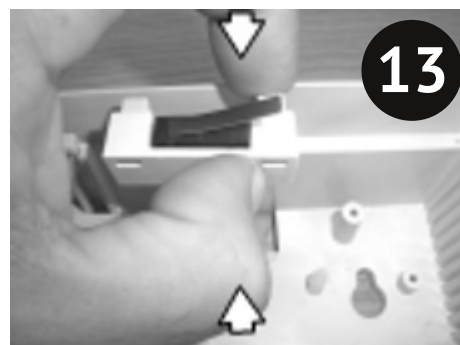

...AND PRESS BY FINGERS

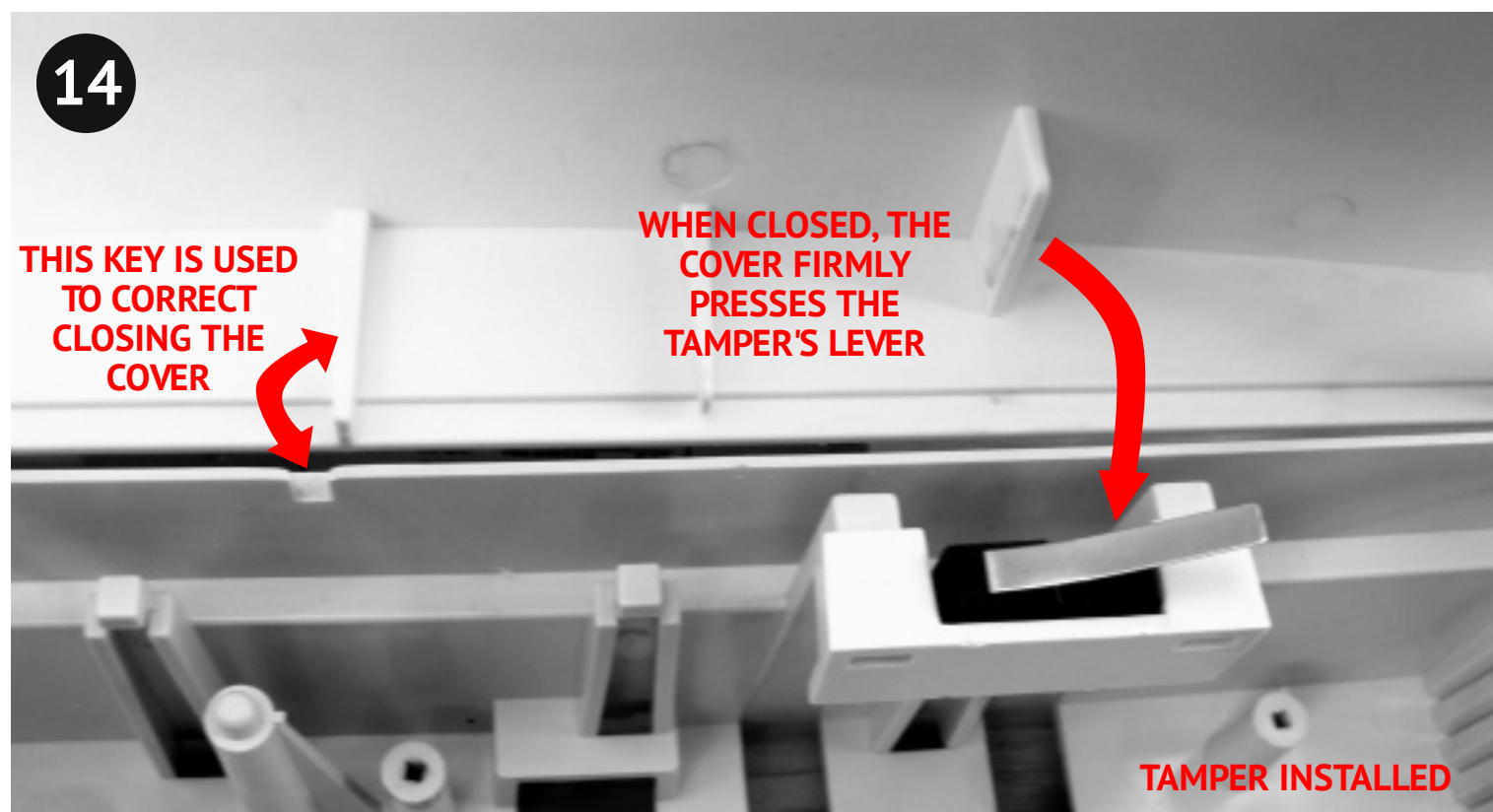

**HOUSING OPENING
TAMPER INSTALLING**

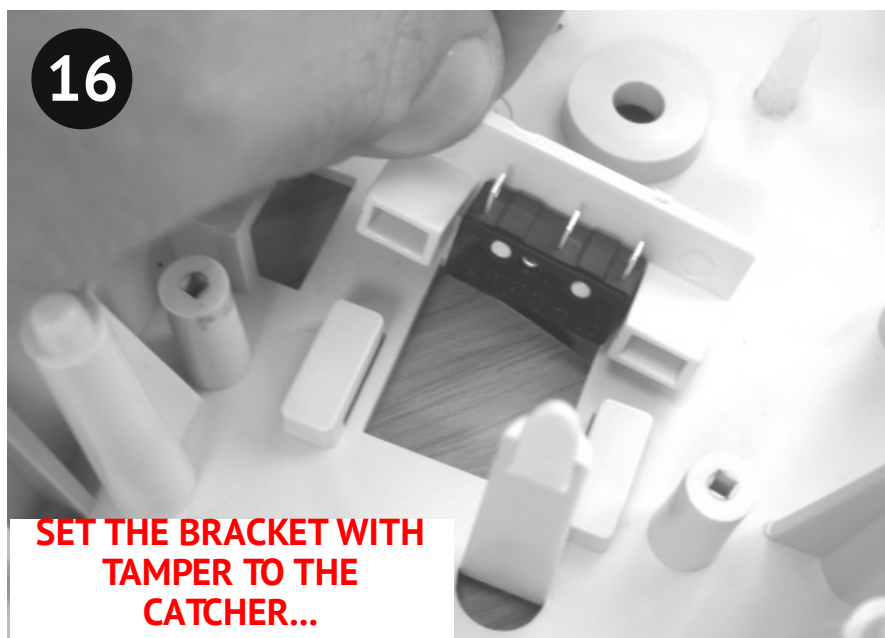
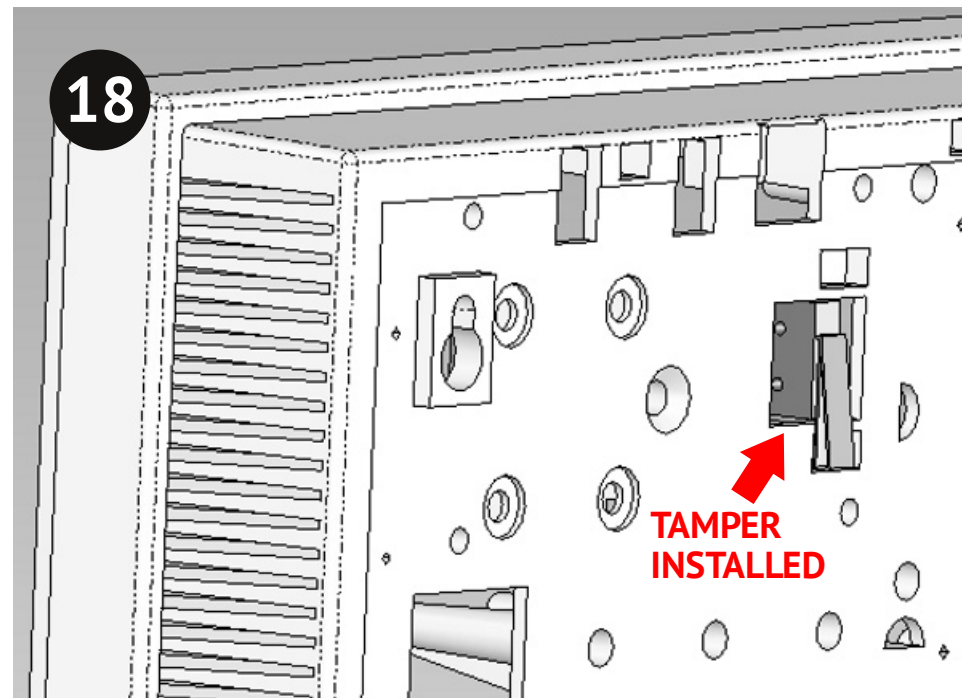

...AND PRESS BY FINGER

**HOUSING SHIFTING
TAMPER INSTALLING**

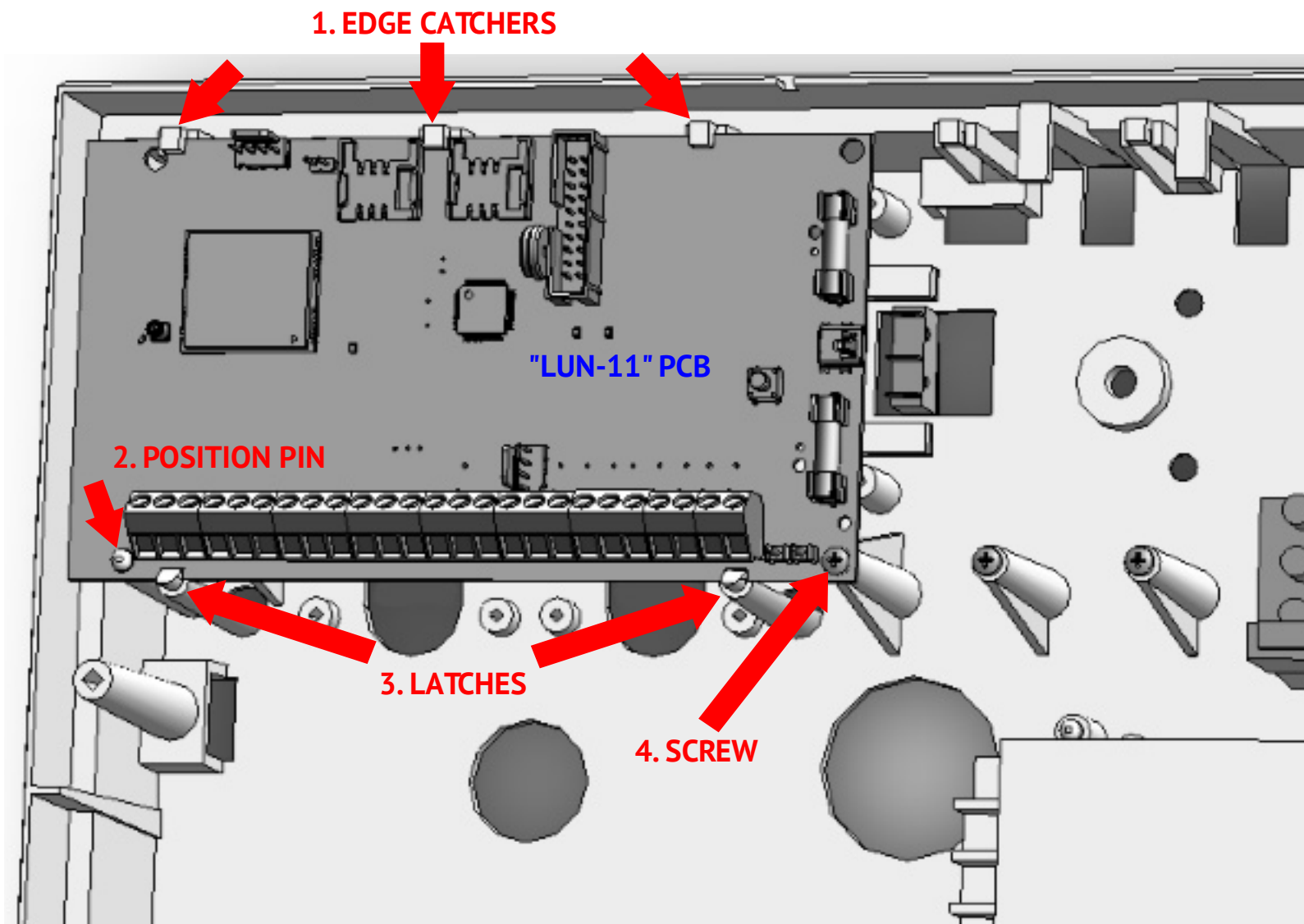

1. PLACE PCB TO EDGE CATCHERS
2. ALIGN PCB HOLE TO POSITION PIN
3. SLIGHTLY PUSH THE BOARD TO FIX LATCHES
4. PLACE SCREW AND TIGHTEN.

"LUN-11" PCB
INSTALLING

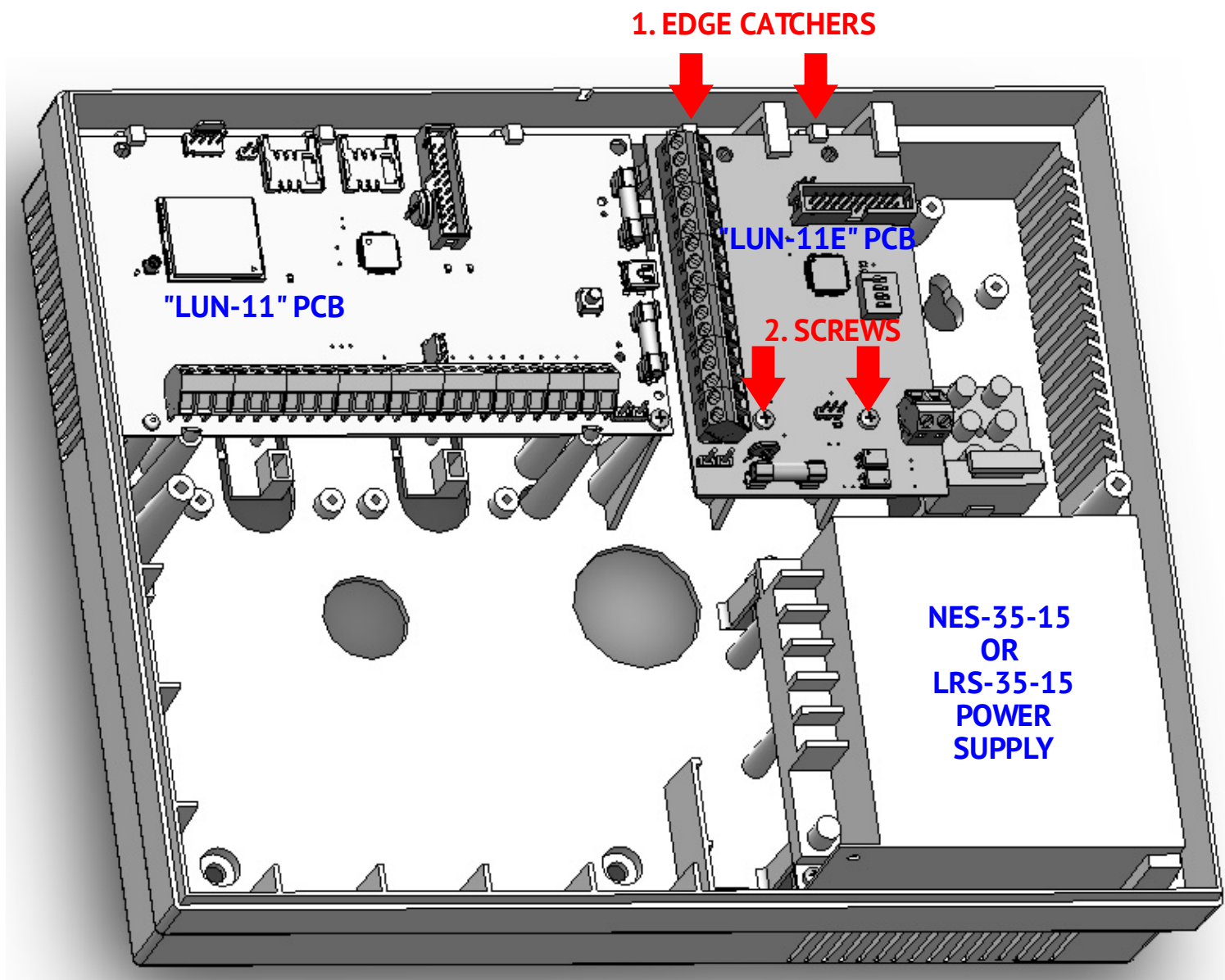

1. PLACE PCB TO EDGE CATCHERS
2. PLACE SCREWS AND TIGHTEN

"LUN-11E" EXTENDER
INSTALLING

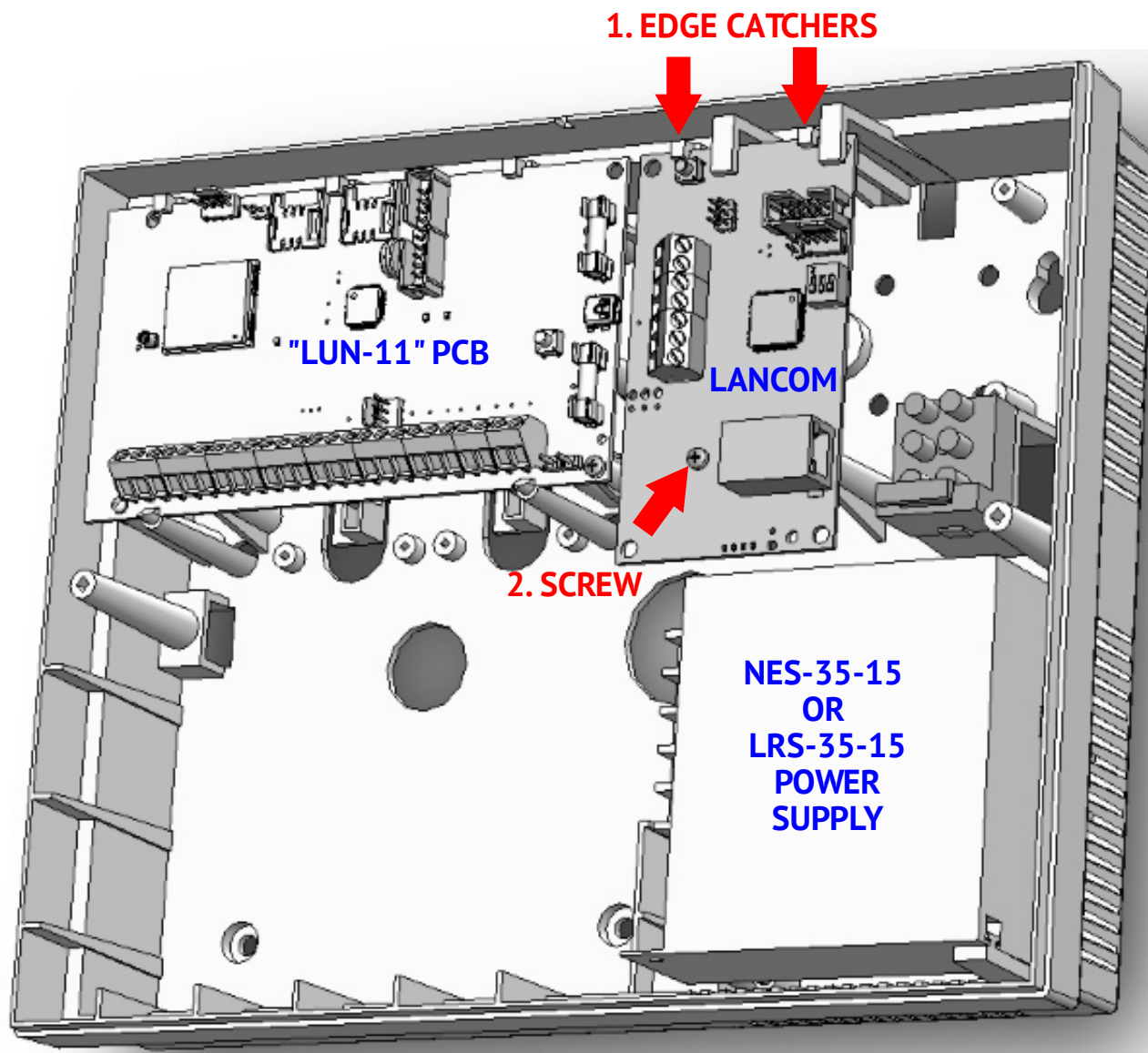

1. PLACE PCB TO EDGE CATCHERS
2. PLACE SCREW AND TIGHTEN

ETHERNET COMMUNICATOR LANCOM INSTALLING

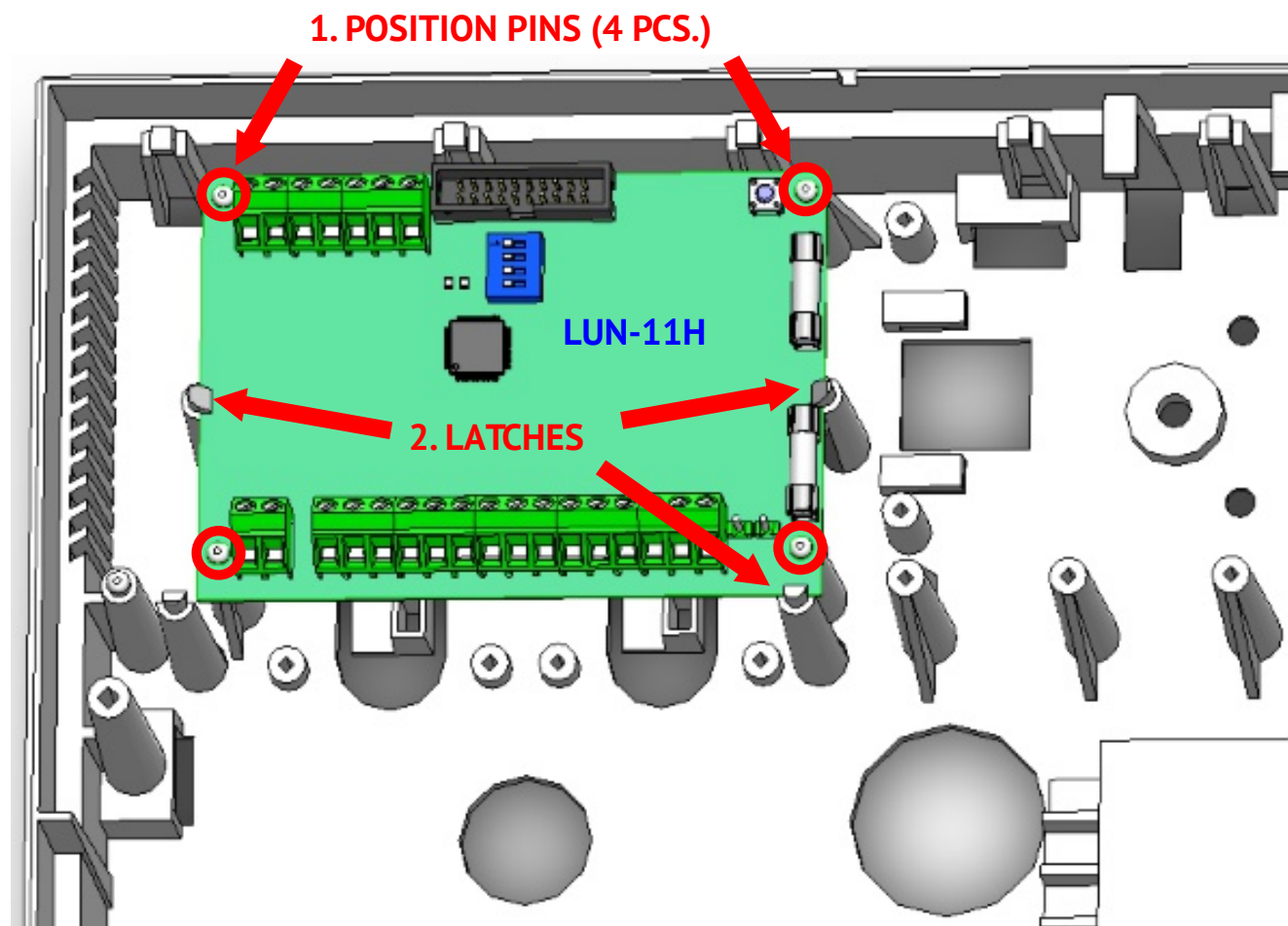

21

1. ALIGN PCB HOLES TO POSITION PINS (4 PCS.)
2. SLIGHTLY PUSH THE BOARD TO FIX LATCHES (3 PCS.)

"LUN-11N" EXTENDER
INSTALLING

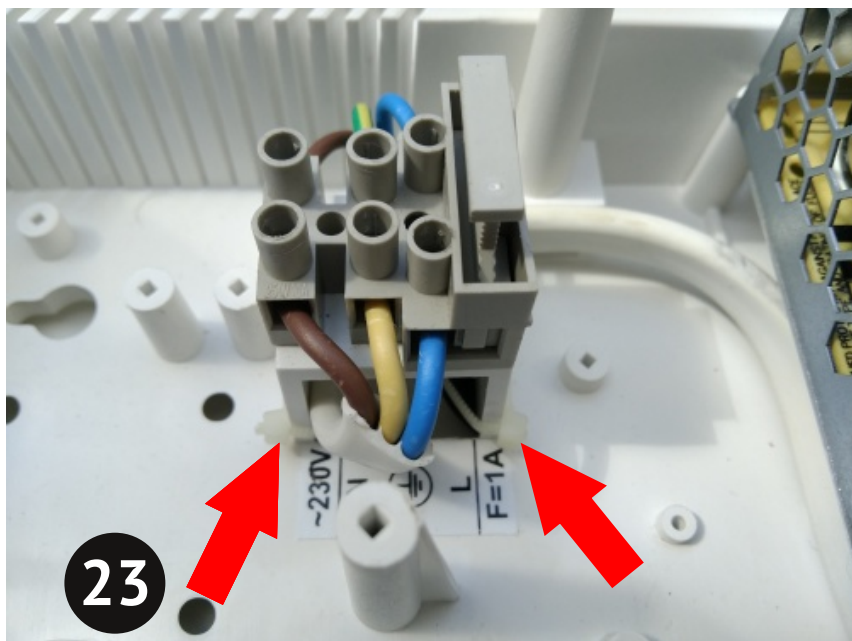

23

**FIX WIRES TO
RACKS BY
STRAPS**

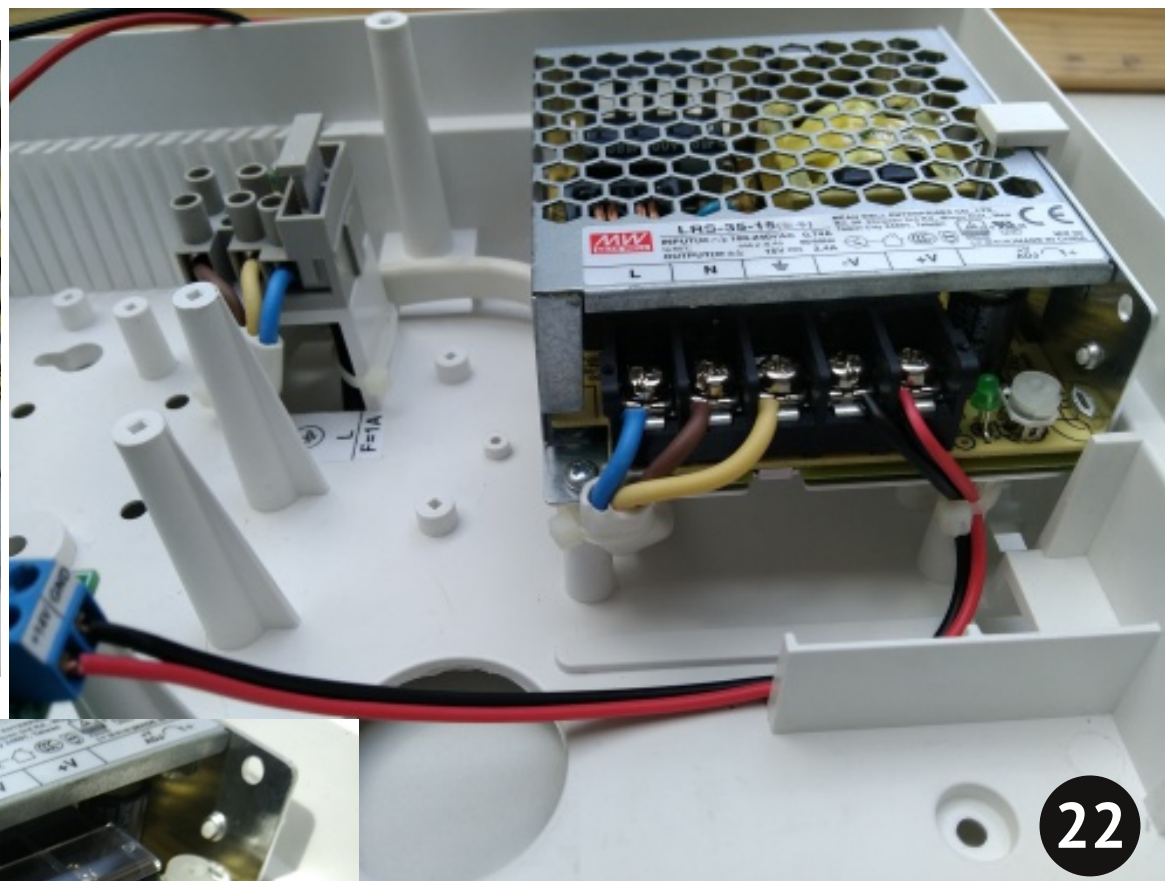

22

**PLACE POWER WIRES AS SHOWN ABOVE
AND WIRING BY SCHEMATIC
(see the Reference Guide)**

**CLOSE THE
TERMINALS
BY COVER**

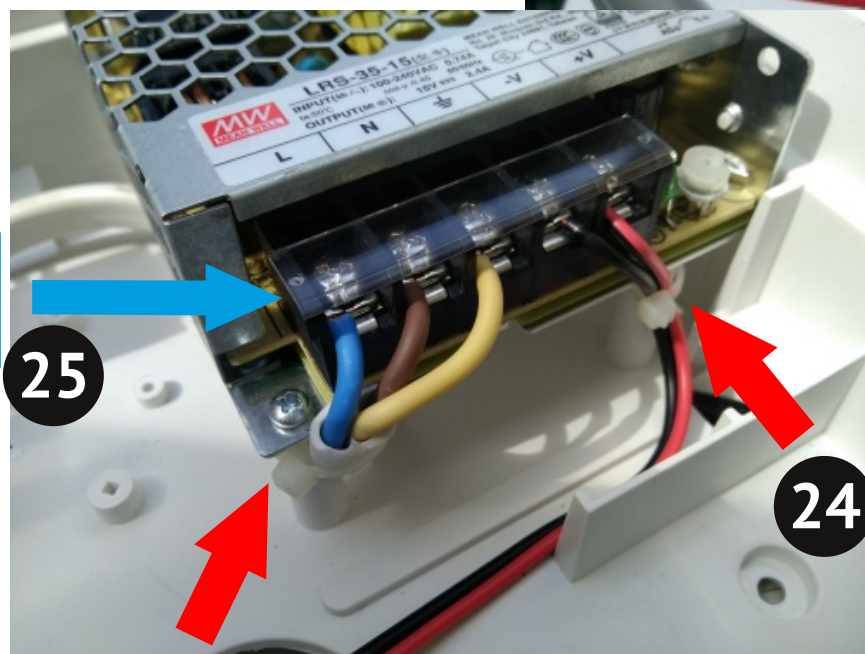

25

24

**FIX WIRES TO
RACKS BY
STRAPS**

WIRING POWER CIRCUITS

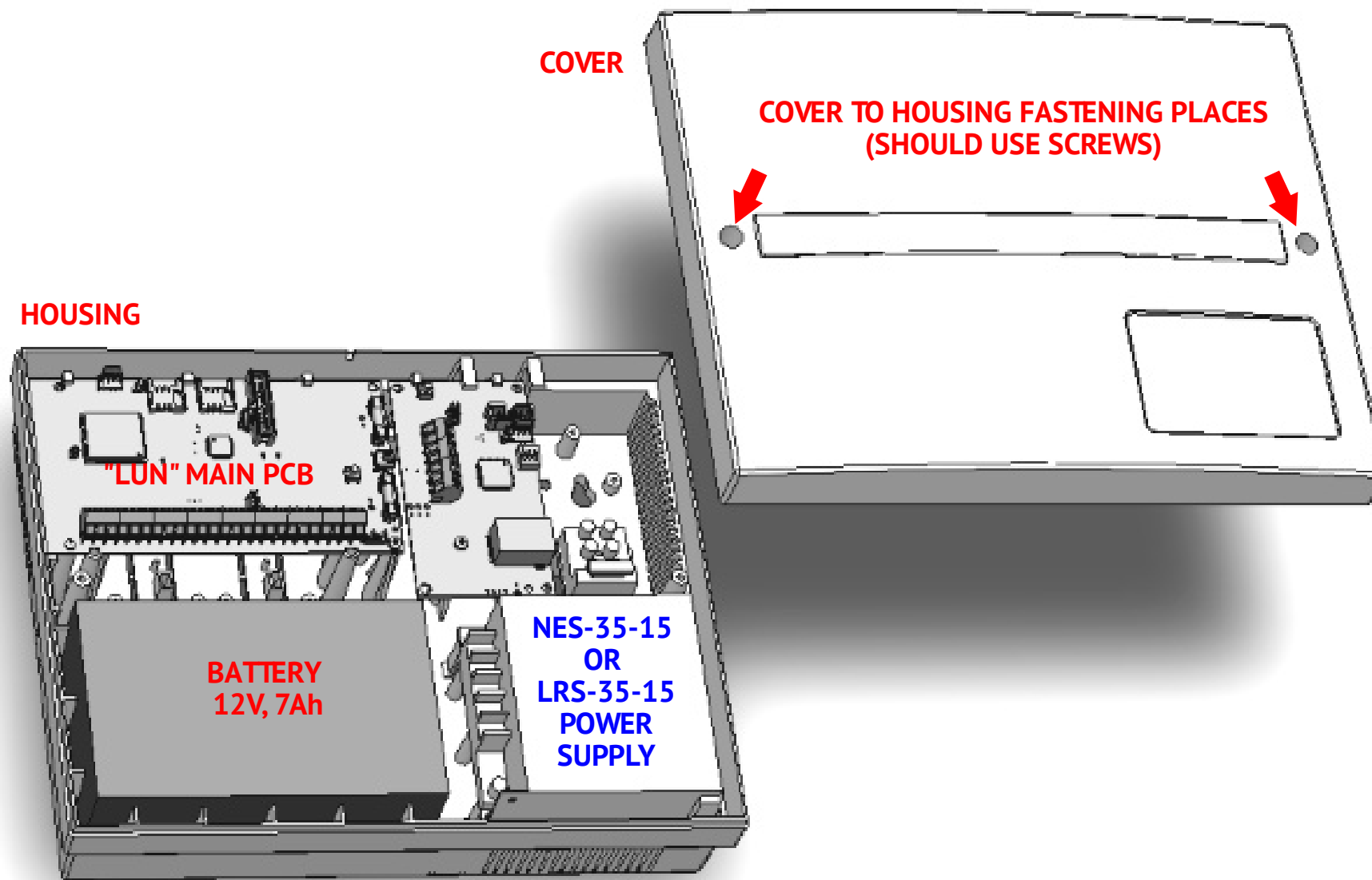

1. INSTALL BATTERY
2. CONNECT "LUN-11" PCB WIRE'S TERMINALS TO BATTERY (RED TO "+", BLACK TO "-")
3. CLOSE COVER
4. PLACE SCREWS (2 PCS.) AND TIGHTEN

**HOUSING FINAL
ASSEMBLY**

**PLACES FOR CABLE CHANNEL INPUT UP TO 15X15mm
(THIN WALLS FOR EASY REMOVAL)**

